

Site Boundary

Block 11 and 12 Elevations

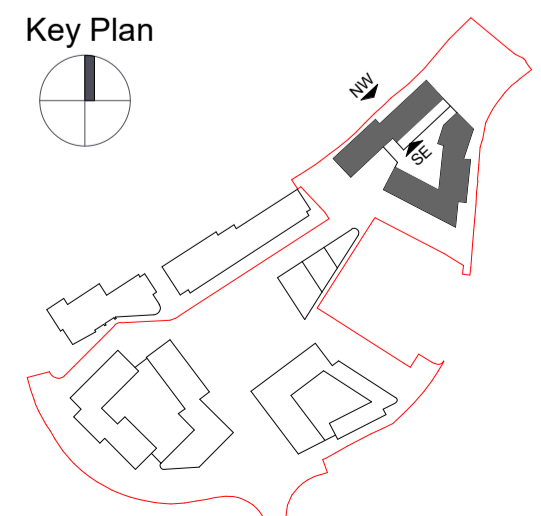

- Material Key**
- 1 Selected brick finish
 - 2 Selected render finish
 - 3 Selected stone / reconstructed stone finish
 - 4 Selected metal cladding
 - 5 Selected metal roofing
 - 6 Selected windows
 - 7 Selected frameless curtain wall system
 - 8 Selected metal louvers
 - 9 Selected metal railing
 - 10 Selected metal balcony
 - 11 Selected glass balustrade
 - 12 Selected winter garden system with metal frame
 - 13 Selected metal frame
 - 14 Selected PV Panels
 - 15 Canopy

Revision Description	Date	Rev. No.	Issued by
SHD Pre-Application to An Bord Pleanála	20-10-2021	C01	CC
SHD Application to An Bord Pleanála	10-06-2022	C02	CC/AN

Figured dimensions only to be used. This drawing is copyright of O'Mahony Pike Architects Ltd. All information is shared as per approved use in accordance with ISO19650-2:2018, Table 5; Standard Codes for Suitability of Models and Documents and the BEP. If the 'Status' field is empty, this information has been shared at 50 - WIP.

omahony pike

architecture | urban design | Dublin | Cork
 email: info@omahonypike.com | The Chapel | One South Mall
 tel: +353 1 202 7400 | Mount St. Anne's | Cork City
 fax: +353 1 283 0822 | Milltown, Dublin 6 | Co. Cork
 www.omahonypike.com | D06 XNS2 Ireland | T12 CCN3 Ireland

Project Code: 1730D
Project Lead: SD
Drawn By: SW
Job No.: 1730D
Purpose: Planning

Scale @ A1: 1 : 200
Date: 10-06-2022
Revision: C02
Status: A3

Project: Jacob's Island Strategic Housing Development
Location: Jacobs Island, Mahon, Co.Cork
Client: Hibernia Star Ltd.

Drawing Title: Block 11 and 12 Elevations
Drawing No.: 1730D-OMP-B11-ZZ-DR-A-2003

Source file: 1730D-OMP-ZZ-22-M3-A-0001.rvt